



E-TRACK

Compact Power Track

User Guide

⚠ PLEASE READ BEFORE USE



⚡ Keep away from fire. ⚡ Not for outdoor use.

🚫 Keep away from water.

Directions For Use (Free-Standing) - Continued



3 Snap support stands onto the rear of E-TRACK. Refer to step 2 for positions of support stands.



4 Place E-TRACK at desired location and connect to the nearest power outlet.

Product Overview

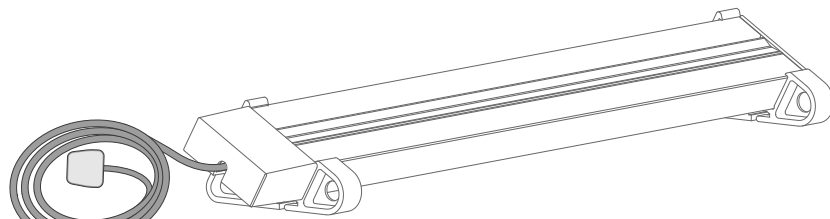

Pre-wired with 3m of 1.5mm² 3-core cable

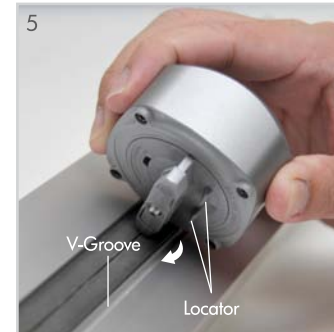

5 Align locator to V-Groove as shown and insert adaptor.



6 Insert plug and turn clockwise to engage power.

Directions For Use (Free-Standing)

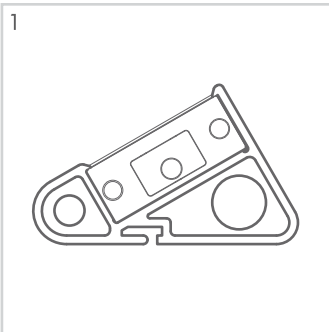

1 Illustration shows orientation of support stands for free-standing.

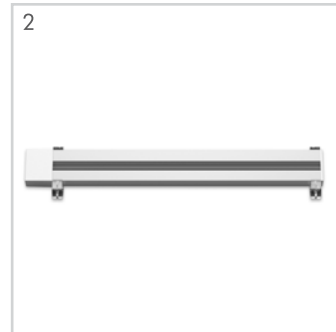

2 Image shows the position of support stands.

3 Years Limited Warranty

1. Eubiq Pte Ltd ("Eubiq") warrants to the end-user of the product ("the Customer") that the product will be free from defects in materials and workmanship under normal use for a period of three (3) years from the date of retail purchase by the original end-user purchaser ("Warranty Period").
2. The Customer should access and refer to Eubiq's website at www.eubiq.com for a list of Eubiq authorised dealers to contact for warranty service.
3. All requests for warranty service must be made within the Warranty Period, and be accompanied by the original dated proof of purchase.

ALL RIGHTS RESERVED. EUBIQ AND GSS ARE THE REGISTERED TRADEMARKS OF EUBIQ PTE LTD.

Directions For Use (Wall-Mount)

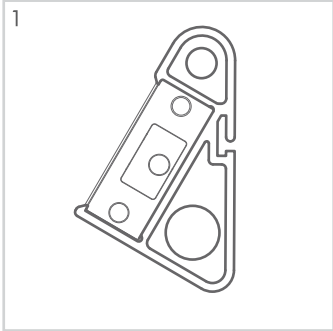

1
Illustration shows orientation of support stands for wall-mounting.

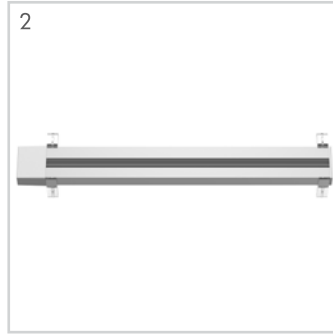

2
Image shows the position of support stands.



3
Snap support stands onto the rear of E-TRACK. Refer to step 2 for positions of support stands.

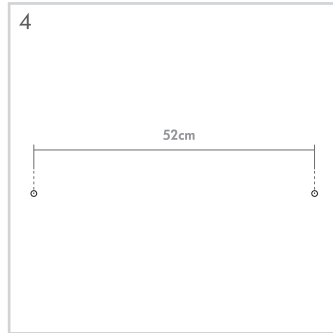

4
Measure and mark the locations for drilled holes as shown at the desired wall-mount location of E-TRACK. Use a levelling tool if necessary.



5
Drill holes on the markings made in step 3.
Concrete Drill bit Ø 5.5mm.



6
Insert wall plugs into the drilled holes, using a mallet if necessary.

Directions For Use (Wall-Mount) - Continued



7
Fasten screws onto the wall plugs. Leave a gap of 4mm between the screw head and the wall surface for mounting.

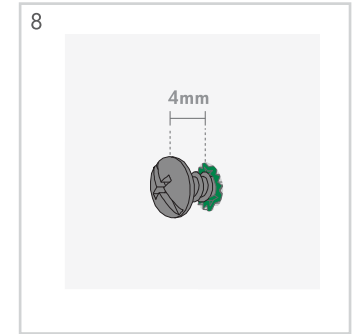

9
Align the opening on the sides of the supports to the screw heads. Slot the E-TRACK onto the screw heads.

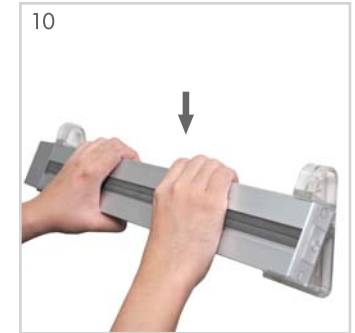

10
Apply a downward force to secure the E-TRACK onto the wall.



11
Align locator to V-Groove as shown and insert adaptor.



12
Insert plug and turn clockwise to engage power.